

// Retail Price List & Product Info Guide



ALTA
WINDOW FASHIONS
design simplified

WINDOW SHADINGS

Pricing effective October 5, 2020 and supersedes all previous pricing.
Subject to change by Alta Window Fashions.

TABLE OF CONTENTS

Product Overview

- Collection Information (includes Light Control) 2-3

Pricing Groups

- Pricing Group 1A (Standard and Options) 4
- Pricing Group 1 (Standard and Options) 5
- Pricing Group 2A (Standard and Options) 6
- Pricing Group 2 (Standard and Options) 7
- Motorization Surcharges 8

Product Specifications

- Features & Options, Cord Loop Drop Chart 9
- Mounting Requirements & Finished Dimensions 10
- Options and Additional Notes 11-13
- Simplicity Rechargeable Motorization: Overview 14
- PowerWand Motorization: Overview 15
- RemoteLift™ 2.0 Product Configuration Specifications 16
- Standard Shading Operation 17
- Retractable Cord and Cordless Shading Operation 18
- Product Components – Standard 19
- Product Components – Retractable Cord 20
- Product Components – Cordless Lift 21
- Product Components – Simplicity Rechargeable Motorization 22
- Product Components – Powerwand™ Motorization 23
- Product Components – Remotelift™ 2.0 24

Oversize Common Carrier Delivery

All orders with any quantity of shades or blinds or any continuous valance 96" or more in width are considered oversize. Therefore, a net shipping charge per oversized unit will be assessed.

Oversized orders that require expedited shipping will be quoted and charged accordingly.

Please see General Information for additional freight and shipping charge information.

COLLECTION INFORMATION

Family Name	Color Name	Family Code	Color #	Coordinating Hardware Color Number	Coordinating Hardware Color Name	Light Control	Price Group
Classic 2-1/2" Translucent N8	Applesauce	N8	226	551	Worn Leather	B	1
	Beige Glow	N8	203	320	Rich Cream	B	1
	Cashmere	N8	206	320	Rich Cream	B	1
	Cityscape	N8	238	426	Squirrel Gray	B	1
	Comfy Khakis	N8	199	180	Dove Gray	B	1
	Dried Basil	N8	065	426	Squirrel Gray	B	1
	Dusky View	N8	208	320	Rich Cream	B	1
	French Bread	N8	222	679	Buff Beige	B	1
	Mariner Blue	N8	224	469	Blue Creek	B	1
	Snow Cap	N8	201	661	White Tiara	B	1
Coastal 2" Translucent SL2	Sun Dream	N8	202	320	Rich Cream	B	1
	Foam	SL2	700	885	Flex White	B	1
	Mystery	SL2	761	426	Squirrel Gray	B	1
	Sand	SL2	701	320	Rich Cream	B	1
	Sculpting Clay	SL2	760	180	Dove Gray	B	1
	Seashell	SL2	703	679	Buff Beige	B	1
Coastal 3" Translucent SA3	Sunrise	SL2	702	320	Rich Cream	B	1
	Foam	SA3	700	885	Flex White	B	1
	Mystery	SA3	761	426	Squirrel Gray	B	1
	Sand	SA3	701	320	Rich Cream	B	1
	Sculpting Clay	SA3	760	180	Dove Gray	B	1
	Seashell	SA3	703	679	Buff Beige	B	1
Dynamic 2-1/2" Translucent DYSS	Sunrise	SA3	702	320	Rich Cream	B	1
	Aspen	DYSS	335	661	White Tiara	B	1A
	Confection	DYSS	333	661	White Tiara	B	1A
	Mystic	DYSS	331	661	White Tiara	B	1A
	Pencil Sketch	DYSS	330	661	White Tiara	B	1A
	Poppyfield	DYSS	334	661	White Tiara	B	1A
Mistral 2-1/2" Translucent MTSS	Tailwind	DYSS	332	661	White Tiara	B	1A
	Bay Leaf	MTSS	300	451	Licen	B	1A
	Casual White	MTSS	304	661	White Tiara	B	1A
	December Gray	MTSS	305	426	Squirrel Gray	B	1A
	Pralline	MTSS	303	350	Vanilla	B	1A
	Sailcloth	MTSS	302	350	Vanilla	B	1A
Passion 2-1/2" Translucent P9	Wildflower	MTSS	301	350	Vanilla	B	1A
	Classic Cream	P9	254	350	Vanilla	B	1
	Destiny's Dream	P9	253	661	White Tiara	B	1
	Heather White	P9	250	661	White Tiara	B	1
	Hint of Spice	P9	255	319	Earthen Beige	B	1
	Spiced Vinegar	P9	251	320	Rich Cream	B	1
Pergola 2-1/2" Translucent PGSS	Touch of Beige	P9	252	320	Rich Cream	B	1
	Butter Cream	PGSS	315	350	Vanilla	B	1A
	Canvas	PGSS	313	350	Vanilla	B	1A
	Cobblestone	PGSS	310	426	Squirrel Gray	B	1A
	Cotton Field	PGSS	311	661	White Tiara	B	1A
	Honey Beige	PGSS	314	350	Vanilla	B	1A
Repose 2-1/2" Light Dimming * RPSS	Spring Snow	PGSS	312	885	Flex White	B	1A
	Cloud White	RPSS	325	661	White Tiara	C	2A
	Peaceful	RPSS	322	329	Summer Linen	C	2A
	Sandrift	RPSS	323	320	Rich Cream	C	2A
	Sesame	RPSS	324	320	Rich Cream	C	2A
	Shadow	RPSS	320	426	Squirrel Gray	C	2A
Retreat 2" Light Dimming SR2	Twilight	RPSS	321	661	White Tiara	C	2A
	Alpine	SR2	300	885	Flex White	C	2
	Antique	SR2	302	329	Summer Linen	C	2
	Faded Gray	SR2	331	551	Worn Leather	C	2
	Nickel	SR2	332	426	Squirrel Gray	C	2
	Sunset	SR2	301	320	Rich Cream	C	2
Retreat 3" Light Dimming SR3	Swiss Coffee	SR2	330	656	Golden Straw	C	2
	Alpine	SR3	300	885	Flex White	C	2
	Antique	SR3	302	329	Summer Linen	C	2
	Ash Gray	SR3	351	426	Squirrel Gray	C	2
	Cloud	SR3	309	320	Rich Cream	C	2
	Coffee Bean	SR3	308	849	Mocha	C	2
	Faded Gray	SR3	331	551	Worn Leather	C	2
	Nickel	SR3	332	426	Squirrel Gray	C	2
	Pebble	SR3	311	810	Mushroom	C	2
	Rock Garden	SR3	350	002	Alabaster	C	2
	Stone	SR3	310	656	Golden Straw	C	2
	Sunset	SR3	301	320	Rich Cream	C	2
	Swiss Coffee	SR3	330	656	Golden Straw	C	2

* Light Dimming fabrics provide category C, opaque light control because even when the vanes are completely closed they DO NOT completely seal off all incoming light. See vane closure diagram on page 16 for a visual reference.

Note: Collections are presented alphabetically. Within each collection colors are also arranged alphabetically



A. Glare Reducing

Softly filters light and reduces glare. Images, shapes and people can be seen clearly. Provides the least amount of light and shape screening.



B. Filtering

Filters strong light. Images, shapes and people can be seen with some clarity. Provides a modest degree of light and shape screening.



C. Shading

Significantly reduces light. Images, shapes and people cannot be seen clearly. Provides a moderate to strong degree of light and shape screening.



D. Blocking

Dramatically reduces light. Images, shapes and people are not distinguishable. Provides privacy against most all direct light and shape screening (except minimal light that may seep through closed or overlapping opaque/blackout vanes).



E. Blackout

Blocks out virtually all light (except light that may enter on the sides of the shade) for maximum privacy and darkness.

COLLECTION INFORMATION

Family Name	Color Name	Family Code	Color #	Coordinating Hardware Color Number	Coordinating Hardware Color Name	Light Control	Price Group
Slub Style 2-1/2" Translucent N10	Aloe Vera	N10	065	451	Lichen	B	1
	Chiffon	N10	213	320	Rich Cream	B	1
	Honey Roast	N10	222	679	Buff Beige	B	1
	Misty Seas	N10	238	426	Squirrel Gray	B	1
	Seashell	N10	204	320	Rich Cream	B	1
	Sugar Cane	N10	201	661	White Tiara	B	1
	Tea Time	N10	220	319	Earthen Beige	B	1
Soft Stripe 2-1/2" Translucent N14	Willow Herb	N10	226	551	Worn Leather	B	1
	Banana Split	N14	205	350	Vanilla	B	1
	Crème Brûlée	N14	203	320	Rich Cream	B	1
	Ground Ginger	N14	226	551	Worn Leather	B	1
	Honey Butter	N14	222	679	Buff Beige	B	1
	Swan Song	N14	201	661	White Tiara	B	1
Solitude 2-1/2" Light Dimming M16	Vanilla Milk Shake	N14	204	320	Rich Cream	B	1
	Citron	M16	205	350	Vanilla	C	2
	Jute	M16	203	679	Buff Beige	C	2
	Parchment	M16	201	320	Rich Cream	C	2
	Soft Souffle	M16	204	551	Worn Leather	C	2
	Sunlit Crème	M16	202	320	Rich Cream	C	2
Sophisticate 2" Translucent SS2	Swan White	M16	200	661	White Tiara	C	2
	Applesauce	SS2	607	350	Vanilla	B	1
	Blue Wave	SS2	630	469	Blue Creek	B	1
	City Sidewalk	SS2	631	810	Mushroom	B	1
	Egg nog	SS2	605	320	Rich Cream	B	1
	Glacier	SS2	616	661	White Tiara	B	1
	Lily	SS2	601	885	Flex White	B	1
	Mist	SS2	602	661	White Tiara	B	1
	Moonlight	SS2	603	320	Rich Cream	B	1
	Natural Linen	SS2	619	002	Alabaster	B	1
	Opal	SS2	604	320	Rich Cream	B	1
	Pearl Grey	SS2	617	320	Rich Cream	B	1
	Pencil Sketch	SS2	632	426	Squirrel Gray	B	1
	Praline	SS2	609	350	Vanilla	B	1
	Sandstone	SS2	606	319	Earthen Beige	B	1
	Treasure Map	SS2	633	002	Alabaster	B	1
Sophisticate 3" Translucent SS3	Applesauce	SS3	607	350	Vanilla	B	1
	Blue Wave	SS3	630	469	Blue Creek	B	1
	City Sidewalk	SS3	631	810	Mushroom	B	1
	Egg nog	SS3	605	320	Rich Cream	B	1
	Glacier	SS3	616	661	White Tiara	B	1
	Lily	SS3	601	885	Flex White	B	1
	Mist	SS2	602	661	White Tiara	B	1
	Moonlight	SS3	603	320	Rich Cream	B	1
	Natural Linen	SS3	619	002	Alabaster	B	1
	Opal	SS3	604	320	Rich Cream	B	1
	Pearl Grey	SS3	617	320	Rich Cream	B	1
	Pencil Sketch	SS3	632	426	Squirrel Gray	B	1
	Praline	SS3	609	350	Vanilla	B	1
	Sandstone	SS3	606	319	Earthen Beige	B	1
	Treasure Map	SS3	633	002	Alabaster	B	1
Villa 2-1/2" Light Dimming N6	Castle Stone	N6	226	551	Worn Leather	C	2
	Coral	N6	202	320	Rich Cream	C	2
	Cotton	N6	201	885	Flex White	C	2
	Fawn	N6	203	320	Rich Cream	C	2
	Graphite	N6	238	426	Squirrel Gray	C	2
	Island Blue	N6	224	469	Blue Creek	C	2
	Spanish Olive	N6	065	451	Lichen	C	2
	White Sand	N6	213	885	Flex White	C	2

* Light Dimming fabrics provide category C, opaque light control because even when the vanes are completely closed they DO NOT completely seal off all incoming light. See vane closure diagram on page 16 for a visual reference.

Note: Collections are presented alphabetically. Within each collection colors are also arranged alphabetically



A. Glare Reducing

Softly filters light and reduces glare. Images, shapes and people can be seen clearly. Provides the least amount of light and shape screening.



B. Filtering

Filters strong light. Images, shapes and people can be seen with some clarity. Provides a modest degree of light and shape screening.



C. Shading

Significantly reduces light. Images, shapes and people cannot be seen clearly. Provides a moderate to strong degree of light and shape screening.



D. Blocking

Dramatically reduces light. Images, shapes and people are not distinguishable. Provides privacy against most all direct light and shape screening (except minimal light that may seep through closed or overlapping opaque/blackout vanes).



E. Blackout

Blocks out virtually all light (except light that may enter on the sides of the shade) for maximum privacy and darkness.

2 1/2" Translucent
 Dynamic (DYSS)
 Mistral (MTSS)
 Pergola (PGSS)

GROUP 1A

WIDTH TO:	24"	30"	36"	42"	48"	54"	60"	66"	72"	76"	84"	90"	96"	102"	109"	120"
HEIGHT TO:																
36"	\$329	371	412	454	494	539	577	620	728	771	814	857	897	953	1067	1165
42"	346	393	437	482	527	574	620	666	776	824	870	917	961	1022	1143	1248
48"	368	413	464	511	562	611	665	715	827	877	926	975	1026	1087	1217	1328
54"	381	436	488	544	597	651	706	767	876	930	983	1039	1097	1164	1306	1425
60"	401	459	515	570	627	693	752	815	923	984	1042	1107	1170	1248	1404	1533
66"	418	481	542	601	666	731	801	868	972	1040	1108	1178	1244	1331	1503	1641
72"	437	503	567	632	703	776	848	919	1026	1098	1171	1244	1317	1410	1594	1740
78"	449	519	589	662	732	809	883	962	1074	1154	1229	1308	1380	1482	1677	1831
84"	467	542	613	694	771	851	933	1014	1130	1215	1295	1375	1455	1561	1769	1931
90"	487	562	641	726	809	896	979	1064	1184	1271	1360	1444	1529	1638	1857	2027
96"	506	587	667	758	848	934	1024	1114	1239	1331	1423	1512	1602	1722	1950	2128
102"	578	670	761	861	952	1038	1159	1273	1362	1454	1548	1636	1727	1836	2072	2262
108"	608	704	801	905	1000	1093	1218	1342	1432	1530	1629	1724	1819	1933	2183	2383
114"	645	748	850	962	1065	1162	1294	1424	1522	1627	1727	1827	1927	2050	2311	2525
120"	694	801	912	1029	1136	1244	1385	1524	1629	1740	1851	1956	2064	2194	2475	2703

STANDARD FEATURES

- Headrail Size: 3-1/4" x 3-1/16"
- Snap-in Bracket Style
- Cord Tilt & Lift
- Color-Coordinated Hardware

OPTIONS: EXTRA CHARGE

- Hardware Color Substitution Surcharge add \$21 per shading
- Cordless Lift Surcharge add \$75 per shading
- Retractable Cord Control Surcharge add \$66 per shading
- Retractable Cord Two-on-One Headrail add \$132
- Motorization see page 7

OPTIONS: NO CHARGE – SPECIFY ON ORDER

- Fabric-Covered Headrail
- Tilt Only Shadings 6" to 11-7/8" (standard only)
- Two-On-One Headrail – price as 2 separate shades (standard)
- Control Positions (R or L)
- Spacer Blocks
- Extension Brackets
- Hold-Down Brackets
- Back Cover for Inside or End Mounts
- Dust Cover for Outside Mounts

SIZE STANDARDS	Standard Loop	Retractable Cord
Minimum ordered width	12"	12"
Minimum ordered width – tilt only	6"	N/A
Maximum ordered width	120"	120"
Maximum ordered width end mount	48"	48"
Maximum ordered width – tilt only	11-7/8"	N/A
Minimum ordered height	16"	16"
Maximum ordered height – translucent	102" or 120"	102" or 120"

* SA3 maximum ordered height is 102"

TWO-ON-ONE HEADRAIL	Standard Loop	Retractable Cord
Minimum ordered width	24"	24"
Maximum ordered width	144"	144"
Maximum height	120"	120"
Center gap	3/8"	3/8"

Note: Two-On-One Headrail option not available for end mount applications.

Note: Two-On-One Headrail option not available with Cordless Lift, RemoteLift 2.0, PowerWand, or Simplicity Motorization

POWERWAND™ UPGRADE	
Minimum ordered width	21"
Maximum ordered width	120"
Maximum ordered width end mount	48"
Minimum ordered height	12"
Maximum ordered height – Translucent	96"
Maximum Square Feet - Translucent	60

SIZE STANDARDS	Cordless Lift
Minimum ordered width	18"
Maximum ordered width	84"
Maximum ordered width end mount	N/A
Minimum ordered height	16"
Maximum ordered height – Translucent	84"

Note: Two-On-One Headrail option not available with cordless lift

Note: End Mount not available with cordless lift

REMOTELIFT 2.0 MOTORIZATION UPGRADE	
Minimum ordered width	12" or 20"
Maximum ordered width	120"
Maximum ordered width end mount	48"
Minimum ordered height	12"
Maximum ordered height – translucent	102" or 120"

* SA3 maximum ordered height is 102"

** Satellite Battery Pack or DC Power Supply = 12" min. Battery Wand = 20" min.

SIMPLICITY MOTORIZATION UPGRADE	
Minimum ordered width	21"
Maximum ordered width	120"
Maximum ordered width end mount	48"
Minimum ordered height	12"
Maximum ordered height – Translucent	96"
Maximum Square Feet - Translucent	60

GROUP 1

 2" Translucent
 Coastal (SL2)
 Sophisticate (SS2)

 2 1/2" Translucent
 Classic (N8)
 Passion (P9)

 2 1/2" Translucent
 Slub Style (N10)
 Soft Stripe (N14)

 3" Translucent
 Coastal (SA3)
 Sophisticate (SS3)

WIDTH TO:	24"	30"	36"	42"	48"	54"	60"	66"	72"	76"	84"	90"	96"	102"	109"	120"
HEIGHT TO:																
36"	\$389	437	486	534	582	635	680	731	859	909	960	1010	1057	1123	1258	1373
42"	408	463	514	569	621	677	731	784	914	972	1025	1081	1132	1204	1346	1472
48"	434	488	548	603	662	721	783	843	975	1034	1091	1150	1211	1282	1435	1566
54"	450	513	574	641	704	767	832	905	1032	1095	1159	1225	1292	1372	1539	1680
60"	473	541	607	672	738	816	886	961	1087	1160	1229	1304	1378	1472	1654	1807
66"	494	567	639	708	784	863	944	1023	1146	1226	1306	1388	1468	1570	1773	1935
72"	514	593	669	746	829	914	1000	1083	1211	1294	1380	1468	1551	1662	1880	2052
78"	529	611	694	780	864	953	1041	1133	1266	1361	1448	1541	1626	1746	1977	2158
84"	551	639	723	818	909	1004	1101	1194	1332	1432	1527	1621	1715	1840	2086	2276
90"	573	662	756	856	953	1056	1155	1255	1396	1498	1602	1702	1801	1931	2190	2389
96"	597	692	786	894	1000	1102	1207	1312	1462	1570	1678	1782	1888	2029	2299	2509
102"	681	791	898	1015	1122	1224	1366	1501	1604	1713	1826	1928	2035	2164	2443	2666
108"	716	830	944	1067	1179	1289	1436	1582	1688	1804	1920	2032	2143	2278	2572	2809
114"	760	880	1003	1133	1256	1370	1526	1679	1794	1918	2035	2154	2272	2416	2725	2976
120"	818	944	1075	1214	1339	1468	1633	1796	1920	2051	2183	2306	2433	2587	2917	3185

STANDARD FEATURES

- Headrail Size: 3-1/4" x 3-1/16"
- Snap-in Bracket Style
- Cord Tilt & Lift
- Color-Coordinated Hardware

OPTIONS: EXTRA CHARGE

- Hardware Color Substitution Surcharge add \$21 per shading
- Cordless Lift Surcharge add \$75 per shading
- Retractable Cord Control Surcharge add \$66 per shading
- Retractable Cord Two-on-One Headrail add \$132
- Motorization see page 7

OPTIONS: NO CHARGE – SPECIFY ON ORDER

- Fabric-Covered Headrail
- Tilt Only Shadings 6" to 11-7/8" (standard only)
- Two-On-One Headrail – price as 2 separate shades (standard)
- Control Positions (R or L)
- Spacer Blocks
- Extension Brackets
- Hold-Down Brackets
- Back Cover for Inside or End Mounts
- Dust Cover for Outside Mounts

SIZE STANDARDS	Standard Loop	Retractable Cord
Minimum ordered width	12"	12"
Minimum ordered width – tilt only	6"	N/A
Maximum ordered width	120"	120"
Maximum ordered width end mount	48"	48"
Maximum ordered width – tilt only	11-7/8"	N/A
Minimum ordered height	16"	16"
Maximum ordered height – translucent	102" or 120"	102" or 120"

* SA3 maximum ordered height is 102"

SIZE STANDARDS	Cordless Lift
Minimum ordered width	18"
Maximum ordered width	84"
Maximum ordered width end mount	N/A
Minimum ordered height	16"
Maximum ordered height – Translucent	84"

Note: Two-On-One Headrail option not available with cordless lift

Note: End Mount not available with cordless lift

TWO-ON-ONE HEADRAIL	Standard Loop	Retractable Cord
Minimum ordered width	24"	24"
Maximum ordered width	144"	144"
Maximum height	120"	120"
Center gap	3/8"	3/8"

Note: Two-On-One Headrail option not available for end mount applications.

Note: Two-On-One Headrail option not available with Cordless Lift, RemoteLift 2.0, PowerWand, or Simplicity Motorization

REMOTELIFT 2.0 MOTORIZATION UPGRADE	
Minimum ordered width	12" or 20"
Maximum ordered width	120"
Maximum ordered width end mount	48"
Minimum ordered height	12"
Maximum ordered height – translucent	102" or 120"

* SA3 maximum ordered height is 102"

** Satellite Battery Pack or DC Power Supply = 12" min. Battery Wand = 20" min.

POWERWAND™ UPGRADE	
Minimum ordered width	21"
Maximum ordered width	120"
Maximum ordered width end mount	48"
Minimum ordered height	12"
Maximum ordered height – Translucent	96"
Maximum Square Feet - Translucent	60

SIMPLICITY MOTORIZATION UPGRADE	
Minimum ordered width	21"
Maximum ordered width	120"
Maximum ordered width end mount	48"
Minimum ordered height	12"
Maximum ordered height – Translucent	96"
Maximum Square Feet - Translucent	60

GROUP 2A

 2 1/2" Light Dimming
 Repose (RPSS)

WIDTH TO:	24"	30"	36"	42"	48"	54"	60"	66"	72"	76"	84"	90"	96"	102"	109"	120"
HEIGHT TO:																
36"	\$364	409	455	501	545	593	635	683	799	849	896	944	987	1049	1177	1284
42"	381	435	481	531	582	632	683	731	856	906	958	1008	1058	1122	1254	1369
48"	403	455	511	562	619	673	730	785	906	963	1018	1073	1128	1196	1341	1464
54"	420	479	539	598	653	715	776	840	962	1024	1080	1144	1210	1281	1441	1574
60"	441	503	566	628	693	759	831	897	1015	1080	1148	1218	1289	1372	1543	1685
66"	460	525	597	665	731	806	880	956	1070	1145	1220	1294	1368	1465	1654	1806
72"	481	552	625	695	774	856	931	1009	1128	1210	1290	1368	1445	1550	1776	1938
78"	494	568	648	727	806	894	973	1059	1182	1267	1355	1438	1520	1630	1905	2080
84"	515	597	673	760	850	935	1027	1114	1244	1336	1424	1596	1668	1735	2043	2230
90"	537	619	703	797	893	984	1078	1169	1299	1397	1571	1667	1739	1847	2144	2340
96"	613	703	796	896	985	1074	1181	1288	1447	1538	1630	1723	1813	1938	2249	2456
102"	703	804	906	1018	1106	1191	1337	1472	1589	1681	1775	1862	1953	2071	2389	2608

STANDARD FEATURES

- Headrail Size: 3-1/4" x 3-1/16"
- Snap-in Bracket Style
- Cord Tilt & Lift
- Color-Coordinated Hardware

OPTIONS: NO CHARGE – SPECIFY ON ORDER

- Fabric-Covered Headrail
- Tilt Only Shadings 6" to 11-7/8" (standard only)
- Two-On-One Headrail – price as 2 separate shades (standard)
- Control Positions (R or L)
- Spacer Blocks
- Extension Brackets
- Hold-Down Brackets
- Back Cover for Inside or End Mounts
- Dust Cover for Outside Mounts

OPTIONS: EXTRA CHARGE

- Hardware Color Substitution Surcharge add \$21 per shading
- Cordless Lift Surcharge add \$75 per shading
- Retractable Cord Control Surcharge add \$66 per shading
- Retractable Cord Two-on-One Headrail add \$132
- Motorization see page 7

SIZE STANDARDS	Standard Loop	Retractable Cord
Minimum ordered width	12"	12"
Minimum ordered width – tilt only	6"	N/A
Maximum ordered width	120"	120"
Maximum ordered width end mount	48"	48"
Maximum ordered width – tilt only	11-7/8"	N/A
Minimum ordered height	16"	16"
Maximum ordered height – light dimming	102"	102"

SIZE STANDARDS	Cordless Lift
Minimum ordered width	18"
Maximum ordered width	84"
Maximum ordered width end mount	N/A
Minimum ordered height	16"
Maximum ordered height – light dimming	84"

Note: Two-On-One Headrail option not available with cordless lift

Note: End Mount not available with cordless lift

TWO-ON-ONE HEADRAIL	Standard Loop	Retractable Cord
Minimum ordered width	24"	24"
Maximum ordered width	144"	144"
Maximum height	102"	102"
Center gap	3/8"	3/8"

Note: Two-On-One Headrail option not available for end mount applications.

Note: Two-On-One Headrail option not available with Cordless Lift, RemoteLift 2.0, PowerWand, or Simplicity Motorization

REMOTELIFT 2.0 MOTORIZATION UPGRADE	
Minimum ordered width	12" or 20"
Maximum ordered width	120"
Maximum ordered width end mount	48"
Minimum ordered height	12"
Maximum ordered height – light dimming	102"

** Satellite Battery Pack or DC Power Supply = 12" min. Battery Wand = 20" min.

POWERWAND™ UPGRADE	
Minimum ordered width	21"
Maximum ordered width	120"
Maximum ordered width end mount	48"
Minimum ordered height	12"
Maximum ordered height - light dimming	84"
Maximum Square Feet - light dimming	50

SIMPLICITY MOTORIZATION UPGRADE	
Minimum ordered width	21"
Maximum ordered width	120"
Maximum ordered width end mount	48"
Minimum ordered height	12"
Maximum ordered height - light dimming	84"
Maximum Square Feet - light dimming	50

2" Light Dimming
 Retreat (SR2)

 2 1/2" Light Dimming
 Solitude (M16)
 Villa (N6)

 3" Light Dimming
 Retreat (SR3)

GROUP 2

WIDTH TO:	24"	30"	36"	42"	48"	54"	60"	66"	72"	76"	84"	90"	96"	102"	109"	120"
HEIGHT TO:																
36"	\$429	481	536	590	642	698	749	805	941	1001	1056	1113	1164	1235	1387	1514
42"	450	512	567	626	686	746	805	863	1009	1069	1128	1188	1247	1323	1478	1614
48"	475	537	603	662	729	794	862	926	1069	1134	1200	1265	1330	1410	1581	1725
54"	496	565	635	705	769	843	915	990	1133	1206	1273	1349	1427	1511	1699	1854
60"	519	593	668	741	816	896	979	1057	1195	1273	1354	1436	1519	1617	1819	1986
66"	542	619	704	783	863	950	1038	1126	1261	1350	1438	1526	1613	1727	1950	2130
72"	567	651	736	819	912	1009	1097	1189	1330	1427	1520	1613	1703	1828	2093	2284
78"	582	670	764	857	950	1053	1148	1248	1394	1493	1597	1695	1792	1922	2245	2451
84"	607	704	794	897	1003	1104	1212	1312	1468	1575	1679	1882	1967	2045	2408	2629
90"	632	729	829	939	1052	1160	1270	1377	1532	1647	1851	1965	2050	2177	2527	2758
96"	723	829	938	1055	1161	1266	1393	1518	1706	1814	1922	2031	2136	2284	2652	2895
102"	828	947	1069	1200	1303	1405	1577	1735	1873	1982	2092	2195	2303	2442	2815	3074

STANDARD FEATURES

- Headrail Size: 3-1/4" x 3-1/16"
- Snap-in Bracket Style
- Cord Tilt & Lift
- Color-Coordinated Hardware

OPTIONS: EXTRA CHARGE

- Hardware Color Substitution Surcharge add \$21 per shading
- Cordless Lift Surcharge add \$75 per shading
- Retractable Cord Control Surcharge add \$66 per shading
- Retractable Cord Two-on-One Headrail add \$132
- Motorization see page 7

OPTIONS: NO CHARGE – SPECIFY ON ORDER

- Fabric-Covered Headrail
- Tilt Only Shadings 6" to 11-7/8" (standard only)
- Two-On-One Headrail – price as 2 separate shades (standard)
- Control Positions (R or L)
- Spacer Blocks
- Extension Brackets
- Hold-Down Brackets
- Back Cover for Inside or End Mounts
- Dust Cover for Outside Mounts

SIZE STANDARDS	Standard Loop	Retractable Cord
Minimum ordered width	12"	12"
Minimum ordered width – tilt only	6"	N/A
Maximum ordered width	120"	120"
Maximum ordered width end mount	48"	48"
Maximum ordered width – tilt only	11-7/8"	N/A
Minimum ordered height	16"	16"
Maximum ordered height – light dimming	102"	102"

SIZE STANDARDS	Cordless Lift
Minimum ordered width	18"
Maximum ordered width	84"
Maximum ordered width end mount	N/A
Minimum ordered height	16"
Maximum ordered height – light dimming	84"

Note: Two-On-One Headrail option not available with cordless lift

Note: End Mount not available with cordless lift

TWO-ON-ONE HEADRAIL	Standard Loop	Retractable Cord
Minimum ordered width	24"	24"
Maximum ordered width	144"	144"
Maximum height	102"	102"
Center gap	3/8"	3/8"

Note: Two-On-One Headrail option not available for end mount applications.

Note: Two-On-One Headrail option not available with Cordless Lift, RemoteLift 2.0, PowerWand, or Simplicity Motorization

REMOTELIFT 2.0 MOTORIZATION UPGRADE	
Minimum ordered width	12" or 20"
Maximum ordered width	120"
Maximum ordered width end mount	48"
Minimum ordered height	12"
Maximum ordered height – light dimming	102"

** Satellite Battery Pack or DC Power Supply = 12" min. Battery Wand = 20" min.

POWERWAND™ UPGRADE	
Minimum ordered width	21"
Maximum ordered width	120"
Maximum ordered width end mount	48"
Minimum ordered height	12"
Maximum ordered height - light dimming	84"
Maximum Square Feet - light dimming	50

SIMPLICITY MOTORIZATION UPGRADE	
Minimum ordered width	21"
Maximum ordered width	120"
Maximum ordered width end mount	48"
Minimum ordered height	12"
Maximum ordered height - light dimming	84"
Maximum Square Feet - light dimming	50

Motorization consists of a **motor, power source, and controller**. Be sure all of these elements are included when determining final price.

SIMPLICITY RECHARGEABLE OPTIONS: EXTRA CHARGE – SPECIFY ON ORDER
 USE APPROPRIATE GRID FOR SHADE PRICE, THEN ADD EXTRA CHARGE(S) BELOW.

• Simplicity Rechargeable Motor	add \$275 per motor
– 5 Channel Remote Control (Black Part #CS5138 or White Part #CS5138W).....	add \$40 each
– Solar Panel (Part #CS52096 Solar Panel & mounting brackets) (Part #02-70-9021 Mounting bracket screws).....	add \$150 each
• PowerWand.....	add \$110 each
• Plug-in Charger (Can be used for both Simplicity Rechargeable and PowerWand) (Part #CH-8.4V-1AN)	add \$30 each

REMOTELIFT™ MOTORIZATION OPTIONS: EXTRA CHARGE – SPECIFY ON ORDER

• Motorization	add \$443 per shading
• Remote Control.....	Part #2984495100 add \$53 each
• Wireless Wall Switch	Part #2986350100 add \$73 each
• Satellite Battery Pack – select with wire length below	Part #KIT2791
• Satellite Battery Pack – with 15" wire.....	Part #2989899000 add \$62 each
• Satellite Battery Pack – with 4' wire	Part #2989900000 add \$69 each
• Satellite Battery Pack – with 10' wire	Part #2989901000 add \$80 each
• Satellite Battery Pack – with 20' wire	Part #2989902000 add \$90 each
• DC Power Supply – select with wire length below	Part #7806000000
• DC Power Supply – with 15" wire.....	Part #2989899000 add \$93 each
• DC Power Supply – with 4' wire	Part #2989900000 add \$94 each
• DC Power Supply – with 10' wire	Part #2989901000 add \$98 each
• DC Power Supply – with 20' wire	Part #2989902000 add \$102 each
• Daisy Chain Adapter – select with wire length below.....	Part #2989875000
• Daisy Chain Adapter – with 15" cable	Part #2989899000 add \$44 each
• Daisy Chain Adapter – with 4' cable	Part #2989900000 add \$50 each
• Daisy Chain Adapter – with 10' cable.....	Part #2989901000 add \$54 each
• Daisy Chain Adapter – with 20' cable.....	Part #2989902000 add \$59 each

Notes: For surcharges on oversize common carrier delivery, express ship program, shipments to Hawaii, Alaska and Puerto Rico, see General Information Section

MOMENTA APP BRIDGE KIT

• Momenta App Bridge Kit (includes one Momenta Extender Kit)	Part #2920072100 (must be submitted as part order).....	add \$128 NET Cost
• Momenta Extender Kit	Part #2920075100 (must be submitted as part order).....	add \$47 NET Cost

Momenta App Bridge Kit (Includes One Momenta Extender Kit)



REMOTELIFT 2.0 ORDERING NOTES

- Specify Inside (IB), outside (OB) or end (EB) mount.
- Specify if optional back cover is desired with inside (IB) mounts or end (EB) mounts.
- Specify if additional spacer blocks or extension brackets are needed for added clearance.
- Specify left- or right-side motor assembly.
- Specify number of remote control units (at least 1 required per order).
- If ordering satellite battery pack, specify wire length (15", 4', 10' or 20').
- If ordering DC power supply, specify wire length (15", 4', 10' or 20').
- Specify if daisy-chain cables are required to daisy-chain 2 or 3 shadings together (requires DC power supply). If ordering, specify wire length (15", 4', 10' or 20')

FEATURES & OPTIONS

FEATURES	
# of fabric styles	16
# of Colors	129
Headrail size	3-1/4" X 3-1/16"
Bracket style	Snap-in
Cord loop tilt and lift	Yes, Standard
Raise, lower and tilt with one cord	Yes
Safety cord tensioner	Color Coordinated
Warranty	Lifetime Limited

OPTIONS - EXTRA CHARGE	
Fabric Covered Headrail	Yes
Hardware Color Substitution	Yes
Retractable Cord Control*	Yes
Cordless Lift <small>Not available as Two-on-One headrail</small>	Yes
PowerWand Motorization <small>Not available as Two-on-One headrail</small>	Yes
Simplicity Motorization <small>Not available as Two-on-One headrail</small>	Yes
RemoteLift 2.0 Motorization <small>Not available as Two-on-One headrail</small>	Yes
OPTIONS - NO CHARGE	
Tilt Only (available on standard loop control only)	Yes
Two-On-One Headrail Option <small>Not available with Cordless Lift, PowerWand, Simplicity Motorization or RemoteLift</small>	Yes
Control positions	Right or Left
Control Positions - PowerWand	Right or Left
Wand Color - PowerWand	White or Black
Wand Length - PowerWand	1 ft, 2 ft, 3ft, 4 ft, 5 ft
Spacer blocks	Yes
Extension brackets	Yes
Hold-down brackets	Yes
Back cover (Inside or End Mounts)	Yes
Dust cover (Outside Mounts)	Yes
Cord length (See Cord Loop Drop Chart)	Yes
Specialty shapes	No
Tile cut-out	No

* Retractable cord length will be 40% of shading height.

CORD LOOP DROP CHART

SHADING HEIGHT	CORD LOOP DROP
16" to 26-7/8"	1 ft. (white-only)
27" to 39-7/8"	2 ft.
40" to 59-7/8"	3 ft.
60" to 83-7/8"	4 ft.
84" to 107-7/8"	5 ft.
108" to 120"	6 ft. (white-only)

OPTIONAL CORD DROPS (White Cord Only)	
CORD DROP	INCREMENTS
6' – 12'	6" increments
12' – 16'	12" increments

Note: 18" white only cords available upon request

MOUNTING REQUIREMENTS

INSIDE MOUNT	
Standard, Cordless, Retractable Cord, Simplicity Motorization, & PowerWand	
Minimum casement depth*	1"
Minimum casement depth*, fully recessed	3-3/8"
Minimum rear fabric clearance	1/8"

OUTSIDE MOUNT	
Standard, Cordless, Retractable Cord, Simplicity Motorization, & PowerWand	
Minimum mounting surface height	1"
Recommended width overlap per side	3"
Minimum rear fabric clearance	1/8"

END MOUNT	
Standard, Retractable Cord, Simplicity Motorization & PowerWand	
Minimum mounting surface depth*	1-1/4"

* Add 1/4" to minimum depth dimensions if optional back cover is used for inside or end mounts.

INSIDE MOUNT - REMOTELIFT 2.0	Battery Wand	Sat. Bat. Pack
Minimum casement depth*	2"	1-1/4"
Minimum casement depth*, fully recessed	4"	3-1/2"
Minimum rear fabric clearance	1/8"	1/8"

OUTSIDE MOUNT - REMOTELIFT 2.0	Battery Wand **	Sat. Bat. Pack
Minimum mounting surface height	1"	1"
Recommended width overlap per side	3"	3"
Minimum rear fabric clearance	1/8"	1/8"

END MOUNT - REMOTELIFT 2.0	Battery Wand	Sat. Bat. Pack
Minimum mounting surface depth*	2-1/8"	1-1/2"

* For inside and end mounts an optional back cover and back cover bracket may be ordered. The back cover bracket attaches to the installation brackets.

** Requires 3/4" spacers per installation bracket (included), due to the added clearance required for the battery wand.

FINISHED DIMENSIONS

Dimensions apply to standard loop control, cordless lift, retractable cord and motorization

NOTE: WIDTH AND HEIGHT MAY VARY $\pm 1/8"$

INSIDE MOUNT – Standard Deductions	
Headrail unit	1/8" less than ordered width
Fabric width	1" less than ordered width
Fabric width - Cordless Lift	3/4" less than ordered width
Shading height	1/8" less than ordered height

OUTSIDE MOUNT – Standard Deductions	
Headrail unit	ordered width
Fabric width	3/4" less than ordered width
Fabric width - Cordless Lift	5/8" less than ordered width
Shading height	1/8" less than ordered height

END MOUNT – Standard Deductions (not available with Cordless Lift)	
Headrail unit	11/16" less than ordered width
Fabric width	1-1/2" less than ordered width
Shading height	1/8" less than ordered height

TWO-ON-ONE HEADRAIL (not available with Cordless Lift, RemoteLift 2.0, Simplicity Rechargeable, or PowerWand)	
Fabric width	1 1/4" less than ordered width
Gap between fabric panels	3/8"

FABRIC GAP – End Gap to Fabric (Gaps On Each Side)	
Control Side	5/8"
Idle Side	3/8"
Both Sides - Cordless Lift	3/8"

OPTIONS

RETRACTABLE CORD

Raise, lower and tilt shadings with one retractable cord. The cord length remains constant when shading is raised or lowered, making it ideal in homes with children or pets. Cord length will be 40% of the shading height and may be shortened for enhanced child safety.

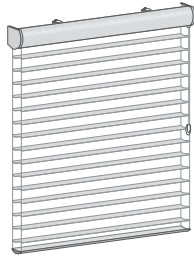

TWO-ON-ONE HEADRAIL

Cover patio doors and other large expanses by placing two independently operated shades side-by-side on the same headrail. Note there will be a 3/8" light gap between the two shades, see minimum/maximum requirements under product specification section.

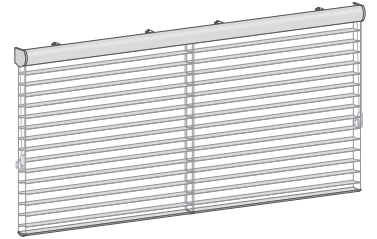

CORDLESS LIFT

Raise, lower, and tilt shadings with cordless lift. A great choice for homes with children and pets, the lift, lower, and tilt mechanism are all controlled by the clear plastic handle attached to the bottomrail.



With your thumb on the front of the handle and fingers on the back, gently pull down to lower the shading. The hinged handle elegantly retracts when released. Continue pulling on the handle to lower the shadings and open the vanes.

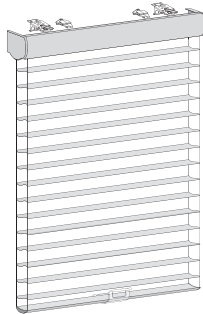

To close the vanes and raise the shades, gently pull down on the handle (about 1") and release. The vanes will close and then the shading will retract into the headrail.

TILT ONLY SHADING

Ideal for sidelights or narrow windows.

- Shading cannot be raised, it can only be tilted open or closed.
- Hold down brackets are used to secure the bottomrail.

FABRIC-COVERED HEADRAIL

Features a coordinating fabric wrapped onto the headrail to provide a soft fabric look from top to bottom. (See surcharge on pricing pages)



OPTIONS

OPTIONAL BACK COVER (INSIDE MOUNT)

Used with inside mounts to conceal the open rear side of the headrail for a more pleasing exterior look. Use of the back cover adds 1/4" to minimum inside mounting depths.

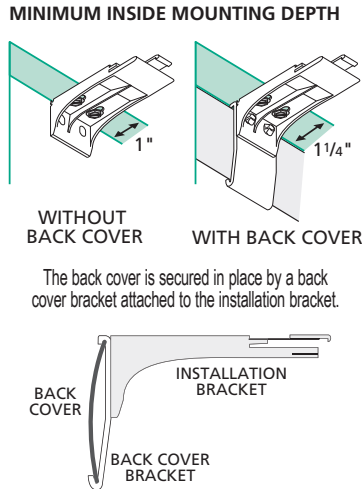

OPTIONAL DUST COVER (OUTSIDE MOUNT)

Shields the fabric and internal headrail components from dirt, dust, and other contaminants.

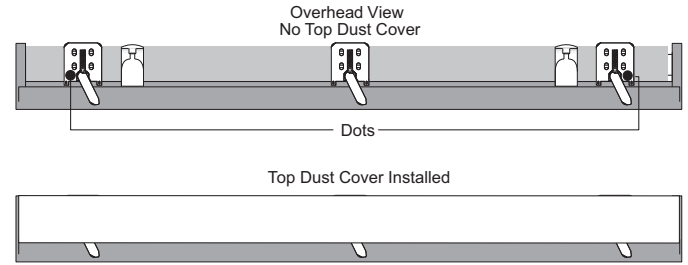

BACK COVER BRACKET

When a back cover is used, attach back cover brackets to the installation brackets before mounting them. Remove the tab from the top of the back cover brackets and both tabs at the rear of the installation brackets.

After mounting the installation brackets, install the back cover.

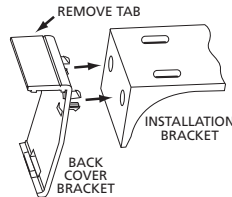

SIDE-BY-SIDE VANE ALIGNMENT

When window shadings are installed side by side, vane alignment can be guaranteed within 1/4" only if:

- Shadings are ordered at the same time and in the identical style, color and height.
- Shadings that need to be aligned are specified on the order form (a note must be included in Special Instructions).
- Shadings exceeding combined width of 120" cannot be guaranteed

Note: Vane alignment cannot be guaranteed for Two-On-One Headrail and motorized shadings combined on the same order.

ADJACENT SHADINGS

To span wide window openings, window shadings may be installed adjacently, so their headrails abut. The gap between the fabric panels of the adjacent shadings varies according to the control placement, as shown in the table below.

CONTROL PLACEMENT	
Adjacent (Abutting) Window Shadings	
Left/Right Shadings	Center Gap
Right/Right Controls	3/4"
Left/Left Controls	3/4"
Right/Left Controls	1-1/16"
Left/Right Controls	1/2"
Window shadings are not recommended for bay windows or butt-and-pass applications.	

ADDITIONAL NOTES

SHADING ADJUSTMENT

Shadings should wind evenly and not skew to one side.

A balance weight on the bottomrail can easily be adjusted if the fabric winds unevenly on the roll when the window shading is raised. Uneven winding can cause damage to the edge of the fabric.

- If skewing does occur:
 - Ensure headrail was installed level; shim if necessary.
 - To release, insert a flat blade screwdriver into the weight lock and turn clockwise.
 - Adjust placement of weight in bottomrail, 1" at a time, toward side where fabric is gathering.
 - Secure the weight locks in position by turning them counter clockwise, after making the adjustment.
 - Raise shade, then lower, if necessary, adjust again.

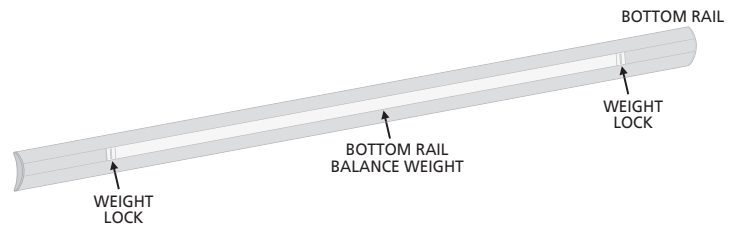

SHADING INSTALLATION

To mount the shading, insert the top of the headrail into the brackets between the locking tab and the bracket flange. Push the headrail into the brackets until the locking tab clicks in place.

To remove the shading, lift the locking tab to release the headrail, rotate the headrail forward, and pull it straight out.

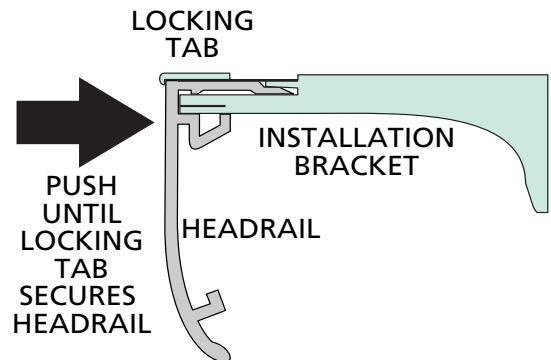

MAGNETIC HOLD-DOWN BRACKETS

Magnetic hold-down brackets secure the bottom of the shading to prevent swaying.

Available upon request. Standard on tilt-only shadings.

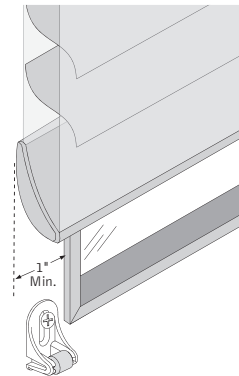

SIMPLICITY RECHARGEABLE MOTORIZATION: OVERVIEW

Simplicity Rechargeable

- The Rechargeable Simplicity motor program features an integrated rechargeable lithium ion battery in the motor casing and is fully concealed by the inner tube.
- Rechargeable battery is included with the motor. The average battery charge will last 6-12 months based on an average sized shade raised and lowered once per day. The life of the battery charge will vary based on the type of window covering selected, the size and weight of the window covering and the number of times the shade is operated on a daily basis. The battery can be recharged up to 500 times. It takes approximately 5 hours to recharge the motor when fully depleted.

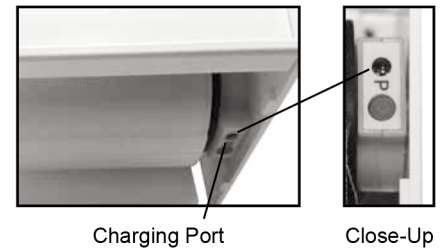

Battery Charger

- An 8.4 Volt charger requires a standard power outlet to recharge the battery. The charger must be specified when ordering Simplicity Rechargeable Motorized shade option. The charger plugs into the charging port of the motor. The charger is black and comes with a 156" wire. The dimensions are 1" wide x 2-1/2" length x 1-3/4" deep. Sold separately.



Solar Panel Recharge Option

- Plugs in to any Simplicity Rechargeable motorized shading (does not work with PowerWand). Provides constant trickle charge to 7.4v Li-ION Rechargeable battery packs. Does not require direct sunlight, but performs best in regular direct sunlight applications. Will prolong the life of the charge of the 7.4v rechargeable battery packs, and in some applications will maintain charge indefinitely.
- Life of charge is subject to application variables such as size and weight of shade, frequency of use, amount of direct sunlight exposure, etc.



5 Channel Remote

- The remote can operate up to five shadings simultaneously, individually or in groups. Remotes and holders are available in white or black. The remote comes with a holder which can be mounted to a wall for easy storage. The range of the remote is approximately 80 feet.



Please Note:

- Not all motors run at the same rate of speed.
- Simplicity motors have a "Favorites" position setting. To set a "Favorites" position, follow instructions provided in the installation instructions.

POWERWAND MOTORIZATION: OVERVIEW

PowerWand™ Motorization

- Shadings can be fabricated with the PowerWand Rechargeable Push Button Control option.
The PowerWand Rechargeable option is an easy, cord free motorized operation for the budget savvy homeowner. PowerWand Rechargeable uses Simplicity motors and components.

PowerWand Rechargeable Shades Operation

- Press the up or down button on the pendant to raise or lower the shading to your desired position.
No programming is required with PowerWand as upper and lower limits are set at the factory. If desired, upper and lower limits can be adjusted in the field.
- Please refer to the installation instructions for instructions on resetting the upper and lower limits and setting a favorites position can be programmed on-site.

PowerWand Appearance

- The PowerWand Rechargeable wand and pendant is attached to the head rail and requires no additional mounting.
- The wand and pendant hangs down the front of the shades from the head rail.
- Pendant is 2-1/2" long.
- The pendant does not need to be mounted to the wall to operate the shade.

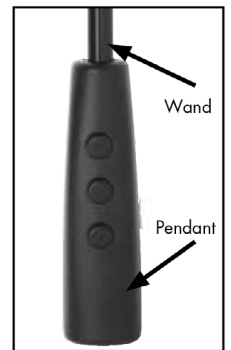

PowerWand Options

- Wand is available in Black or White (there is no default).
- Wand is available in 1 foot increments from 1 to 5 feet (there is no default).
- Wand is available on the left or right side of shade (there is no default).

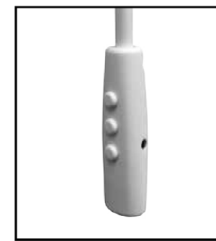

White



Black Shown with
Plug-In Charger

PowerWand Battery Life

- The battery life will vary based on the type of window covering selected, the size and weight of the window covering and the number of times you operate the blind on a daily basis.

Battery Charger

- 8.4 Volt charger requires a standard power outlet to recharge the battery. The charger must be specified when ordering the PowerWand motorization option. The charger plugs into the charger port on the side of the pendant.
The charger is black and comes with a 156" wire.
The dimensions are 1" wide x 2-1/2" length x 1-3/4" deep.



REMOTELIFT™ 2.0 PRODUCT CONFIGURATION SPECIFICATIONS

RemoteLift 2.0 combines IR and RF wireless signals to control your window shadings. By using both line-of-sight (infrared technology) and "out-of-sight" (radio frequency technology), your customers achieve more operating flexibility. RemoteLift 2.0 operates one window at a time or a group of windows, even in multiple rooms.

- Quieter, more robust motor for raising, lowering and tilting shadings
- Ideal option for hard-to-reach windows behind furniture, above counters, in high foyers, etc.
- Enhanced safety in homes with children and pets
- State-of-the-art convenience; multiple options allow even further customization of window shadings
- Battery-powered system is easy to install and requires no additional wiring



REMOTELIFT 2.0 SYSTEM OPTIONS

BATTERY WAND

Battery wands are the standard power source whether inside (IB), outside (OB) or end (EB) mount, if applicable. Battery wands are mounted on the rear of the headrail. The redesigned battery wand will allow for batteries to be changed without removing the window covering from the window.

- 12 AA 1.5V alkaline batteries.
- Battery life exceeds one year, depending on usage.
- Replace batteries when the window covering(s) begin to operate slowly.



18V Battery Wand

SATELLITE BATTERY PACK

The satellite battery pack is an optional power source. The battery pack connects to the same side of the headrail where the receiver eye or satellite eye is located. The satellite battery pack is the best choice when the window covering is mounted in a high window, restricting access to a battery wand.

- 18V satellite battery pack:
 - Available in 15", 4', 10' and 20' wire lengths.
 - 12 AA 1.5V alkaline batteries.
- Battery life is approximately one year, depending on usage.
- Replace batteries when the window covering(s) begin to operate slowly.
- Mounting options: top of headrail, next to molding or under the sill.
- Satellite battery pack cover can be painted.



18V Satellite Battery Pack

DC POWER SUPPLY

The DC power supply is an optional power source. The DC power supply plugs into any standard household outlet.

- 18V DC power supply:
 - Available in 15", 4', 10' and 20' wire lengths.
- Eliminates need to change batteries.



18V DC Power Supply

DAISY CHAIN

The optional Daisy Chain Adapter allows up to 3 shades to run off of one DC power supply. You must specify the cable wire length when order is placed.

Note: Keep in mind which side the sensor eye is positioned on each side when determining daisy-chain length.



Daisy-Chain Adapter/Connector

STANDARD SHADING OPERATION

Shadings are operated using a continuous cord loop. As shown in the illustration below, from the fully raised position [1] pulling down on the rear half of the cord loop lowers the shading [2, 3]. After it is fully lowered, continuing to pull down on the cord pivots the bottomrail and opens the fabric vanes [4]. When the vanes are fully open [5], limit stops in the headrail prevent further movement in that direction.

With the fabric vanes fully open, pulling down on the front half of the cord loop first closes the vanes [6, 7] and then raises the window shading [8]. When it is fully raised [1], limit stops again halt shading movement, preventing the bottomrail from being retracted too far into the headrail.

Light Control

With the shading in the fully lowered position, the continuous cord loop is used to adjust the fabric vanes from open to closed, and anywhere in between. Light control is at your customer's fingertips. (Note: The degree of maximum vane closure varies slightly from the top to the bottom of the shading.)

Vane Opening

Vane opening is the amount of unobstructed visibility between fully open vanes when looking through the shading at eye level. Vane opening for shadings is 1" to 1-1/2" depending on vane size and opacity.

- 2" Light Dimming = 1"
- 2" and 2-1/2" Translucent, 2-1/2" Light Dimming = 1-1/4"
- 3" Translucent and Light Dimming = 1-1/2"

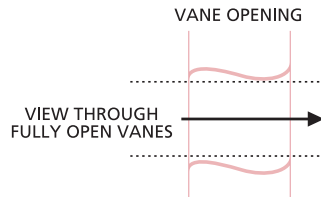

Vane Closure

When the vanes of a window shading are closed, they overlap each other, blocking the view. However, the vanes do not contact each other along the full length of the shading – they do not form a perfect seal against light leakage. This is most visible toward the bottom of the shading. Vane closure is measured

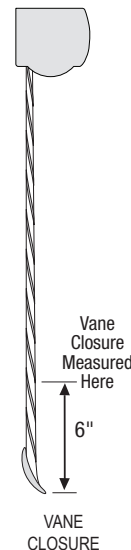

as the distance between the front and rear fabric facings 6" up from the lowest point of the bottomrail, with the shading fully lowered and the vanes closed, as illustrated here. Vane closure for all fabrics is 1".

Note: The degree of maximum vane closure varies slightly from top to bottom of the shading.

- Over-rotation can occur when the shading is completely lowered and vanes are opened. The bottom rail turns up to the inside of the opening when the vanes are in the horizontal position.

Note: Over-rotation is an inherent characteristic of Window Shadings. The amount of over-rotation may vary from shade to shade.

PLEASE NOTE:

- Cord tensioner **MUST** be mounted to window casement or wall in order for the shade to operate.
- As with all textiles, Window Shading fabrics are subject to some variations. Slight wrinkles, puckering or bowing is inherent to textile products and should be considered normal, acceptable quality.

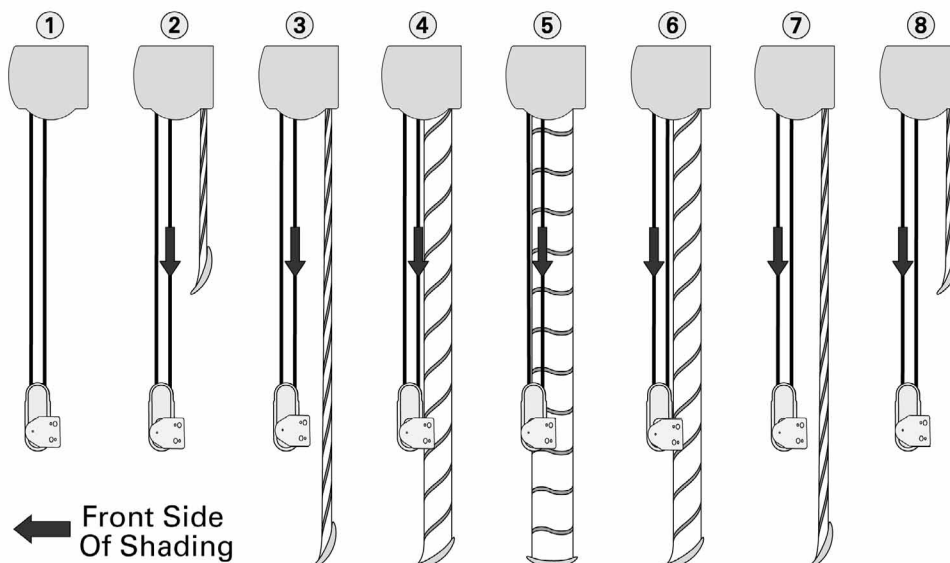

OPERATION

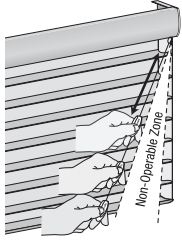

RETRACTABLE CORD

To Lower the Shading

To lower shading and open vanes, pull cord toward the center and down in long even strokes. Note: Allow cord to fully retract between each stroke.

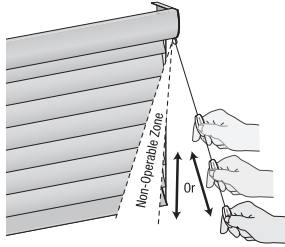

To Close and Raise the Shading

To close vanes and raise shading, pull cord straight down or down and slightly out using long even strokes.

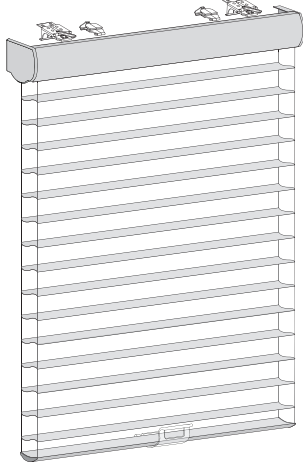

CORDLESS LIFT

Raise, lower, and tilt shadings with cordless lift. A great choice for homes with children and pets, the lift, lower, and tilt mechanism are all controlled by the clear plastic handle attached to the bottom rail.

With your thumb on the front of the handle and fingers on the back, gently pull down to lower the shading. The hinged handle elegantly retracts when released. Continue pulling on the handle to lower the shadings and open the vanes.

To close the vanes and raise the shades, gently pull down on the handle (about 1") and release. The vanes will close and then the shading will retract into the headrail.



PRODUCT COMPONENTS – STANDARD

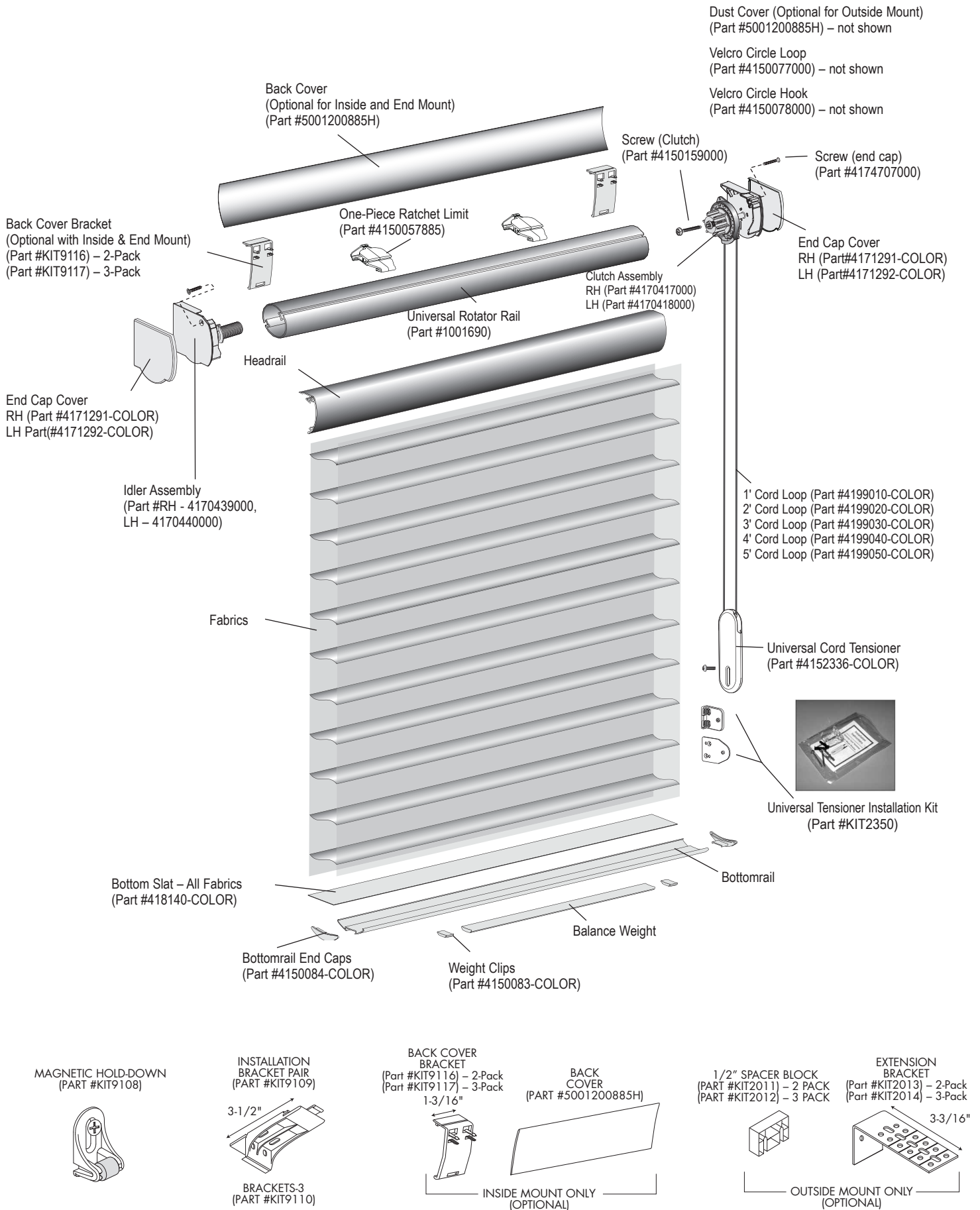

PRODUCT COMPONENTS – RETRACTABLE CORD

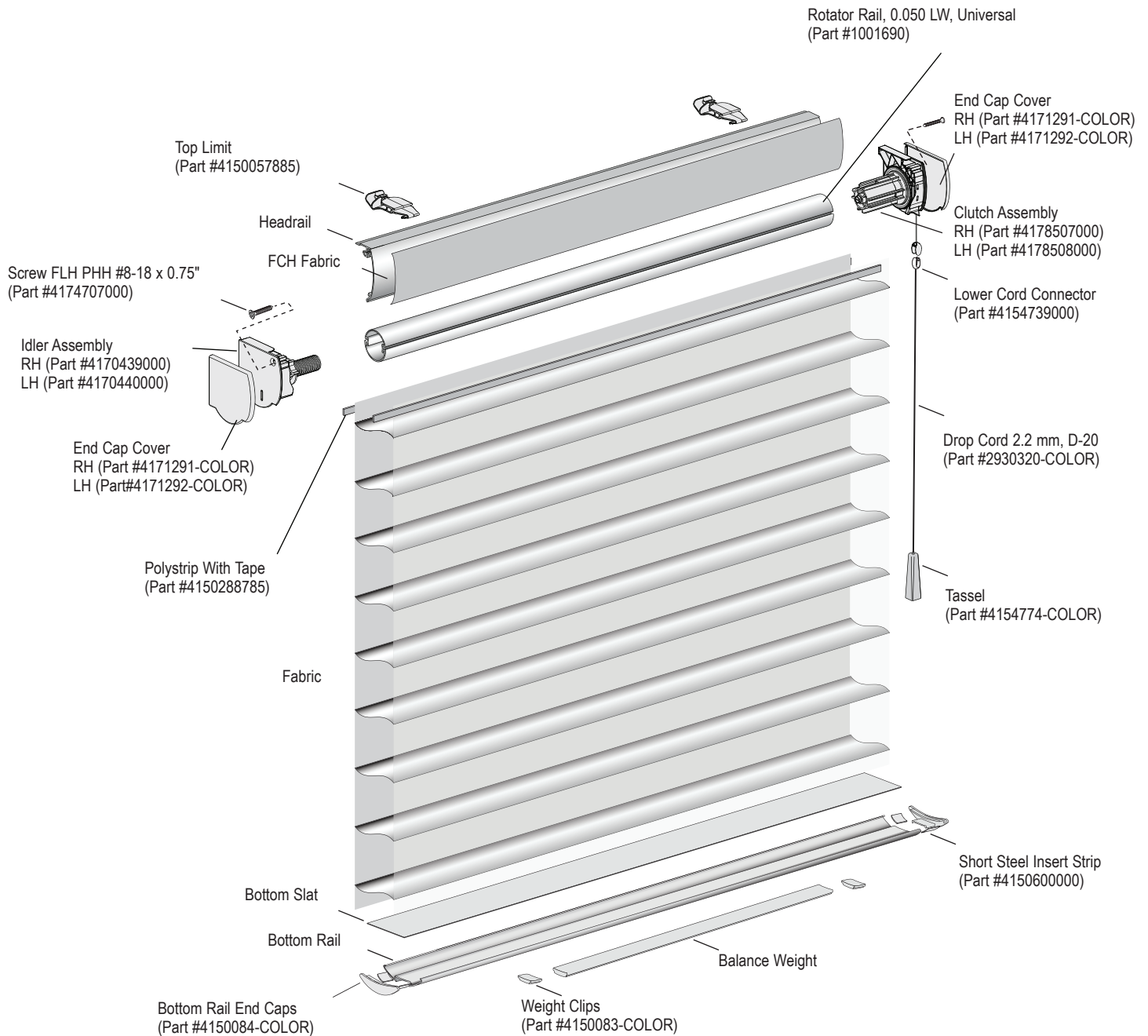

PRODUCT COMPONENTS – CORDLESS LIFT

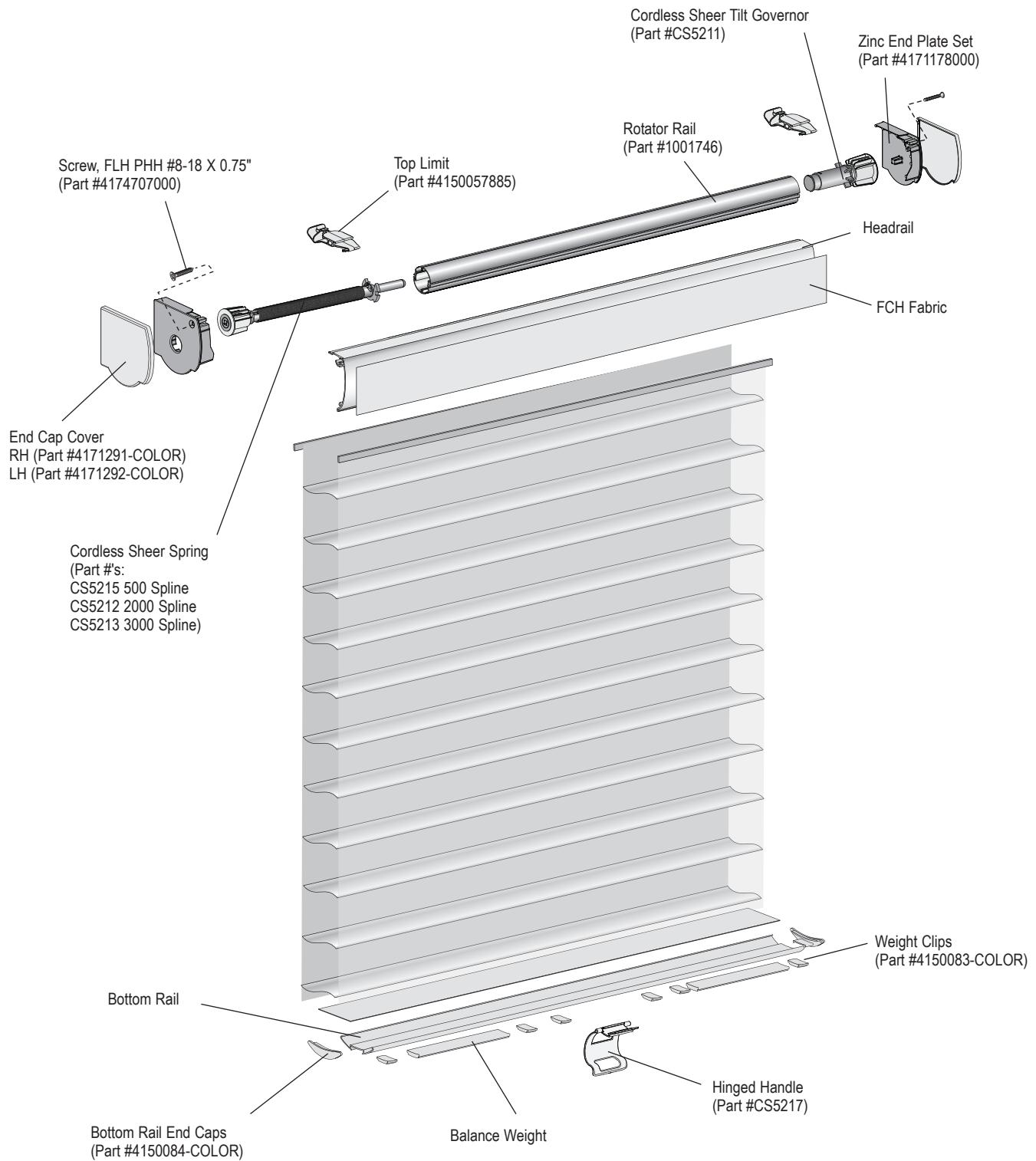

PRODUCT COMPONENTS – SIMPLICITY RECHARGEABLE MOTORIZATION

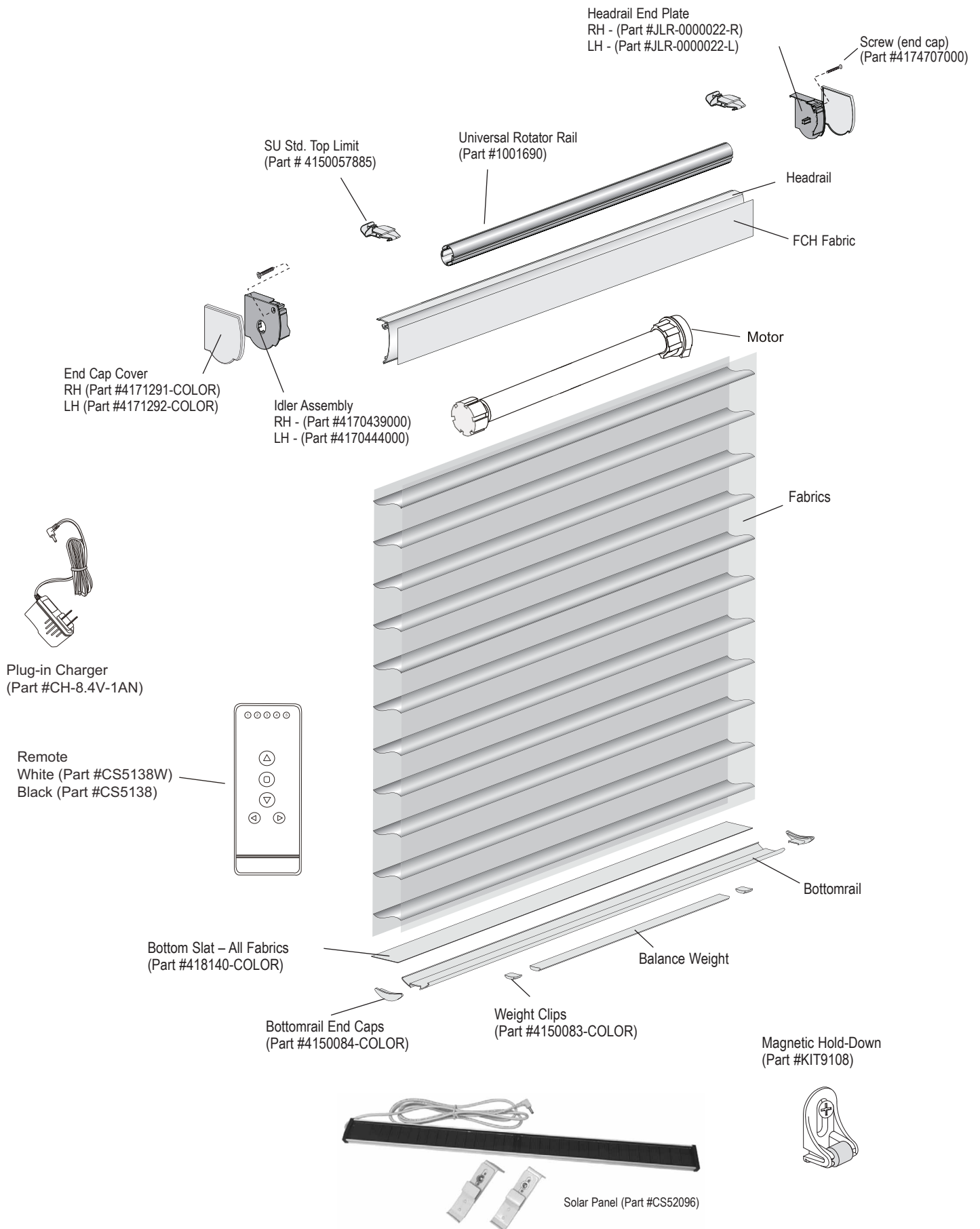

PRODUCT COMPONENTS – POWERWAND MOTORIZATION

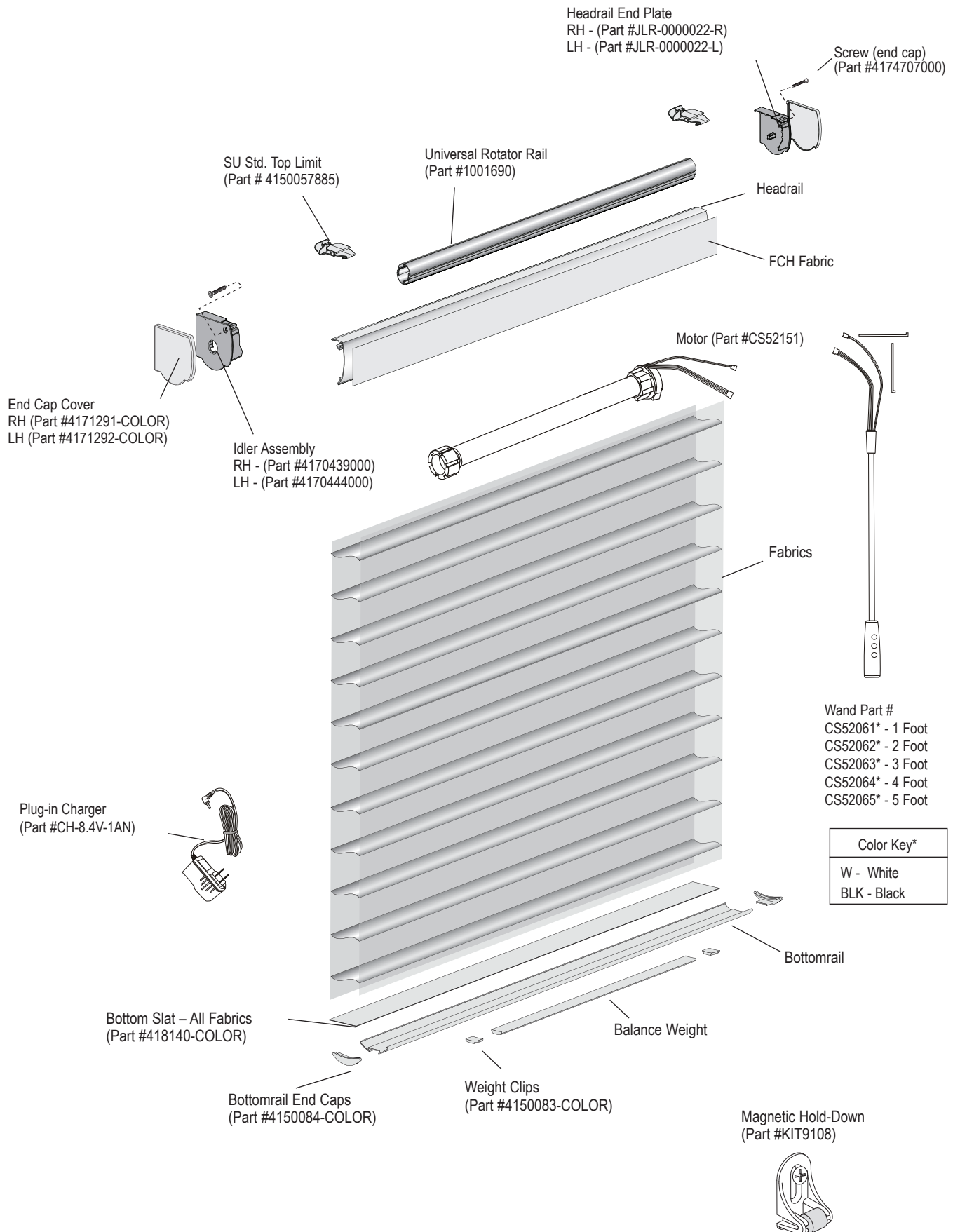

PRODUCT COMPONENTS – REMOTELIFT™ 2.0

